

03000 HYDRAULIC MANIFOLD CIRCUIT

The Matweld Hydraulic Manifold Circuit is a self contained flow and directional control assembly. The manifold can be installed on any vehicle which is already equipped with a hydraulic system capable of producing at least 10 gpm at 2000 psi. The manifold can be installed and takes up very little space. The manifold circuit provides a safe and cost effective way of adding hydraulic tool capabilities to your existing fleet of equipment.

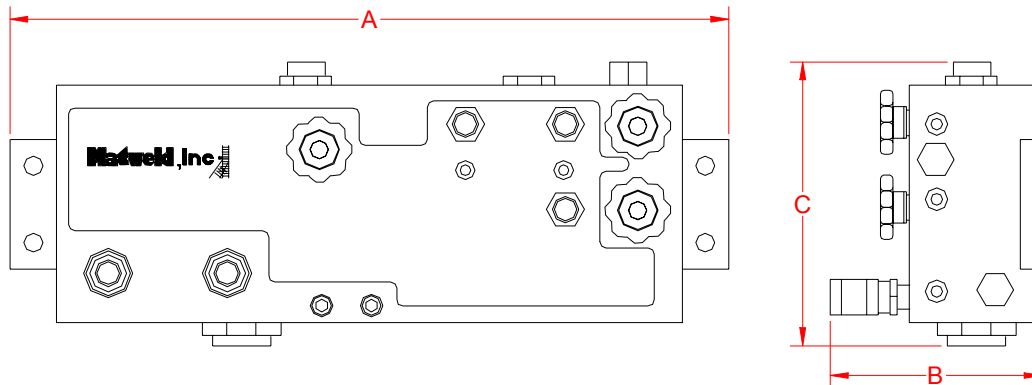

FLOW	PRESSURE	DIMENSIONS	WEIGHT
1-10 gpm (38 lpm) or 2-5 gpm (19 lpm)	2000 psi (140 bar)	A - 18-3/4" B - 7" C - 8-1/2"	30 lbs (13.61 kg)

MATWELD, INC.

PHONE:(270) 444-0085

FAX:(270) 443-6180

Matweld reserves the right to change parts, features, or specifications without notice.

GENERAL SAFETY PRECAUTIONS:

TOOL OPERATORS AND MAINTENANCE PERSONNEL MUST ALWAYS COMPLY WITH THE SAFETY PRECAUTIONS GIVEN IN THIS MANUAL, AND WITH ALL STICKERS AND TAGS ATTACHED TO THE TOOL AND HOSE. ALL SAFETY PRECAUTIONS ARE GIVEN FOR YOUR SAFETY. READ TO UNDERSTAND AND FOLLOW ALL SAFETY, MAINTENANCE AND OPERATION INSTRUCTIONS BEFORE YOU USE OR MAINTAIN THE TOOL. REVIEW THE MANUAL DAILY BEFORE USING THE TOOL. IN ADDITION, FOLLOW ALL SAFETY GUIDELINES GIVEN YOU BY YOUR SUPERVISOR. DO NOT USE THE TOOL IF YOU HAVE ANY QUESTIONS ABOUT THE OPERATION, SAFETY OR MAINTENANCE OF THIS TOOL. FAILURE TO FOLLOW THESE INSTRUCTIONS CAN RESULT IN PERSONAL INJURY OR EQUIPMENT DAMAGE.

MATWELD HAS NO CONTROL OVER TOOL USE OR OPERATION ONCE IT LEAVES THE MATWELD PLANT. MATWELD HAS NO CONTROL OVER OPERATOR OR MAINTAINER SELECTION. THE CUSTOMER MUST ASSUME RESPONSIBILITY FOR THE TOOL'S SUITABILITY FOR A PARTICULAR FUNCTION. DURING USE OF TOOL, GOOD JUDGEMENT MUST BE USED TO WORK SAFELY AND EFFICIENTLY WITHOUT ENDANGERING THEMSELVES OR BYSTANDERS. UNDERSTANDING OF THE OPERATION AND MAINTENANCE MANUAL IS ESSENTIAL FOR ANYONE USING OR MAINTAINING THE TOOL.

- DO NOT OPERATE THE TOOL UNTIL YOU HAVE BEEN THOROUGHLY AND PROPERLY TRAINED OR UNDER THE SUPERVISION OF AN INSTRUCTOR.
- CHECK POWER SOURCE DAILY TO DETERMINE IF CORRECT FLOW AND PRESSURE ARE AVAILABLE. NEVER EXCEED FLOWS OR PRESSURES FOR THE TOOL BEING USED. PERSONAL INJURY OR DAMAGE TO THE TOOL CAN RESULT.
- OPERATORS MUST CLEAR THE WORK AREA OF NON-ESSENTIAL PERSONNEL. FLYING DEBRIS CAN CAUSE SERIOUS INJURY.
- THE OPERATOR MUST BE FAMILIAR WITH ALL PROHIBITED WORK AREAS SUCH AS UNSAFE GRADES, POOR FOOTING AREAS AND OVERHEAD HAZARDS.
- MAINTAIN BALANCE AND PROPER FOOTING AT ALL TIMES. NEVER OVERREACH TO THE EXTENT THAT A BROKEN PART OR SUDDEN MOVEMENT OF THE TOOL CAN CAUSE YOU TO LOSE YOUR BALANCE AND FALL, OR CAUSE INJURY TO YOUR SELF OR SOMEONE ELSE.

- WHEN WORKING NEAR ELECTRICAL CONDUCTORS, ALWAYS ASSUME THAT THE CONDUCTORS ARE ENERGIZED AND THAT HOSES AND CLOTHING CAN CONDUCT HARMFUL ELECTRICITY. USE HOSES LABELED AND CERTIFIED AS NON-CONDUCTIVE.
- DO NOT OPERATE THE TOOL AT EXCESSIVE FLUID TEMPERATURES OPERATOR DISCOMFORT AND POTENTIAL BURNS CAN RESULT AT HIGH OIL TEMPERATURES.
- NEVER WEAR LOOSE CLOTHING THAT CAN GET ENTANGLED IN THE WORKING PARTS OF THE TOOLS OR BE CARELESS WITH HANDS, FEET OR OTHER BODY PARTS AROUND THE WORKING PARTS OF THE TOOLS. HYDRAULIC TOOLS EXERT HIGH TORQUE AND FORCE AND CAN CAUSE SERIOUS INJURY OR DEATH IF IMPROPERLY USED.
- TO AVOID PERSONAL INJURY OR EQUIPMENT DAMAGE, ALL TOOL REPAIR, MAINTENANCE OR SERVICE MUST ONLY BE PERFORMED BY AUTHORIZED AND PROPERLY TRAINED PERSONNEL.
- ALWAYS WEAR SAFETY EQUIPMENT SUCH AS OIL INJECTION RESISTANT WORK GLOVES, SAFETY GLASSES, SAFETY BOOTS, EAR PROTECTION AND OTHER SAFETY APPAREL DICTATED BY YOUR SUPERVISOR APPLICABLE FOR THE JOB YOU ARE DOING AND THE TOOL YOU ARE USING.
- DO NOT CLEAN INSPECT OR REPAIR THE TOOL WHILE CONNECTED TO THE POWER SOURCE. ACCIDENTAL ENGAGEMENT OF THE TOOL CAN CAUSE SERIOUS PERSONAL INJURY.
- OIL INJECTION HAZARD EXISTS WITH THIS TOOL. OIL INJECTION IS A CONDITION WHERE HYDRAULIC OIL IS INJECTED UNDER THE SKIN FROM PRESSURE IN THE LINE. ALWAYS WEAR GLOVES AND REPAIR ANY LEAKS IMMEDIATELY. NEVER CARRY A TOOL BY THE HOSES.
- DO NOT USE DAMAGED EQUIPMENT. IMMEDIATELY REPLACE ANY DAMAGED HOSES, FITTINGS, OR OTHER COMPONENTS SHOWING WIRE BRAID, NICKS, CUTS, DAMAGE OR ABRASIONS. FAILURE TO DO SO MAY RESULT IN EQUIPMENT DAMAGE AND / OR PERSONAL INJURY OR DEATH.
- CLEAN UP ANY OIL OR FLUID SPILLS IMMEDIATELY.

SAFETY PRECAUTIONS:

1. **ALWAYS** WEAR PROTECTIVE EQUIPMENT SUCH AS GLOVES, SAFETY GLASSES, EAR PROTECTION AND SAFETY SHOES.
2. DO NOT WEAR CLOTHING WHICH MAY BECOME ENTANGLED IN THE TOOL.
3. **ALWAYS** KEEP WORK AREA FREE OF TOOLS OR ANY OTHER OBJECTS WHICH MAY IMPAIR SOUND FOOTING.
4. **CAUTION** OIL INJECTION HAZARD EXISTS WITH THIS TOOL. OIL INJECTION IS A CONDITION WHERE THE HYDRAULIC OIL IS FORCED UNDER THE SKIN THROUGH PRESSURE IN THE LINE. ALWAYS WEAR GLOVES, DO NOT CARRY THE TOOL BY HYDRAULIC HOSES, AND REPAIR LEAKS IMMEDIATELY..
5. **NEVER** CHANGE STONES WITH THE POWER SOURCE VALVE(S) IN THE “**ON**” POSITION, TURN THE POWER SOURCE “**OFF**”.
6. **NEVER** ATTEMPT TO CARRY THE GRINDER WITH THE POWER SOURCE IN THE “**ON**” POSITION, TURN THE POWER SOURCE “**OFF**”.
7. **NEVER** TOUCH OR TRY TO STOP A MOVING STONE.
8. **ALWAYS** CHECK THE WORK AREA FOR ANY TRASH WHICH MAY IGNITE FROM SPARKS.
9. **ALWAYS** CHECK THE AREA FOR SMOLDERING TIES OR TRASH BEFORE LEAVING THE SITE.
10. WHEN CHANGING STONES, FOLLOW ALL GRINDING STONE MANUFACTURERS INSTRUCTIONS FOR SAFETY AND OPERATION. USE ONLY STONES THAT COMPLY WITH ANSI STANDARDS. BEFORE USING, RUN NEW GRINDING STONE FOR ONE MINUTE AT FULL SPEED TO CHECK FOR DEFECTS OR VIBRATION.
11. MOST HYDRAULIC OILS HAVE A FLASHPOINT OF APPROXIMATELY 450 DEGREES (F). MAKE SURE HOSES ARE COMPLETELY CLEAR OF SPARKS AND HOT DEBRIS. HAVE ANOTHER PERSON STAND CLOSE TO HYDRAULIC POWER SOURCE CONTROLS TO OBSERVE OPERATION AND FOR EMERGENCY SHUTDOWN IF NECESSARY.

03000 HYDRAULIC MANIFOLD CIRCUIT

FLOW: 2 EA. – 5 GPM (19 LPM) OR 1 EA. – 10 GPM (38 LPM)
PRESSURE: 2000 PSI (140 BAR)

PRE-INSTALLATION CHECK PROCEDURE:

1. VERIFY THAT INSTALLATION WILL NOT INTERFERE WITH THE VEHICLES OPERATION, CAUSE DAMAGE TO THE VEHICLE, ASSOCIATED EQUIPMENT OR CREATE SAFETY HAZARDS.
2. VERIFY THE VEHICLE HAS AT LEAST 10 GPM (38 LPM) AND 2000 PSI (140 BAR) CONSTANT CAPABILITY AT THE POINT OF KIT INSTALLATION.
3. VERIFY THAT SYSTEM BACK PRESSURE, AT THE POINT OF INSTALLATION, IS BELOW 50 PSI AT 10 GPM. READ AT THE RETURN QUICK DISCONNECT COUPLER ON 03000 MANIFOLD.
4. VERIFY THAT FLOW, AT POINT OF INSTALLATION, **CANNOT** BE REVERSED BY OTHER VALVING EQUIPMENT.
5. VERIFY THAT, SHOULD OIL TEMPERATURE BE ABOVE 130 DEGREES FAHRENHEIT AFTER TOOLS ARE PUT IN SERVICE ON THE VEHICLE, AN OIL COOLER CAN BE ADDED IF NECESSARY
6. VERIFY THAT, SYSTEM HAS A FILTRATION SYSTEM OF AT LEAST 10 MICRON CAPABILITY.
7. VERIFY THAT, IT WILL BE POSSIBLE TO ADD A ½” LINE **DIRECTLY** TO THE TANK, FOR THE SECONDARY RETURN LINE.
8. VERIFY THAT IN COLD WEATHER OPERATION THE OIL CAN BE WARMED TO 50 +F BEFORE TOOL USE. EXTREMELY COLD WEATHER OPERATION MAY REQUIRE AN “IN TANK” HEATER.

IF ALL OF THE ABOVE CONDITIONS HAVE BEEN MET SUCCESSFULLY, CONTINUE WITH THE INSTALLATION.

03000 HYDRAULIC MANIFOLD CIRCUIT

INSTALLATION:

1. CHOOSE A LOCATION ON THE VEHICLE WHERE IT WILL BE ACCESSABLE TO SERVICE, PROTECTED FROM BEING DAMAGED AND USABLE FOR THE TOOL OPERATORS.
2. MOUNT THE CIRCUIT BLOCK USING THE TABS ON EACH END.
3. INSTALL THE SYSTEM PRESSURE LINE (**FROM PUMP**) TO PORT "P", THIS LINE SHOULD BE A MINIMUM SIZE OF ½".
4. INSTALL THE SYSTEM RETURN LINE (TO TANK OR COOLER) TO PORT "T1", THIS LINE SHOULD BE A MINIMUM SIZE OF ¾". A LARGER SIZE MAY BE NECESSARY IF THE BACK PRESSURE EXCEEDS 50 PSI. (SEE NOTE 3 –PREVIOUS PAGE)
5. INSTALL THE SECONDARY RETURN LINE (**DIRECT TO TANK**) TO PORT "T2", THIS LINE SHOULD BE A MINIMUM SIZE OF ½".

TEST PROCEDURE:

1. TO SET THE TOOL CIRCUIT PRESSURE AT 2000 PSI (140 BAR) PUT A PRESSURE GAUGE ON THE 10 GPM PORT. SET TRUCK RPM TO 10 GPM THROTTLE SETTING.
2. TURN THE **EQUIPMENT/TOOL** CIRCUIT VALVE TO **TOOLS**.
3. TURN BOTH **5 GPM** CONTROL VALVES TO THE "**ON**" POSITION AND READ MAXIMUM PRESSURE ON PRESSURE GAUGE.
4. TO ADJUST THE PRESSURE TO **2000 PSI** (140 BAR), LOOSEN JAM NUT AND TURN THE ALLEN SCREW ON THE RELIEF VALVE CLOCKWISE TO INCREASE THE PRESSURE AND COUNTERCLOCKWISE TO DECREASE THE PRESSURE. RETIGHTEN JAM NUT.
5. TO TEST THE FLOW, INSTALL A FLOW GAUGE ON THE 10 GPM PORT AND CONNECT IT TO EITHER OF THE RETURN COUPLERS. SET TRUCK RPM TO 10 GPM SETTING.
6. TURN THE **EQUIPMENT/TOOL** CIRCUIT VALVE TO **TOOLS**.
7. TURN BOTH **5 GPM** CONTROL VALVES TO THE "**ON**" POSITION.
8. THE FLOW METER SHOULD NOW BE SHOWING 10 GPM.
9. AT 10 GPM THE BACK PRESSURE SHOULD READ 50 PSI OR LESS, MEASURED AT THE MANIFOLD RETURN COUPLER.

03000 HYDRAULIC MANIFOLD CIRCUIT

10. VERIFY THAT FLOW RATE CANNOT EXCEED 10.5 GPM.
 - A.) CONNECT TEST GAUGE TO 10 GPM PORT AND TURN GAUGE TO 10 GPM PORT AND TURN BOTH 5 GPM VALVES ON. (NO HOSES SHOULD BE CONNECTED TO 5 GPM PORTS)
 - B.) SET TRUCK RPM TO 10 GPM THROTTLE SETTING.
 - C.) OBSERVE GAUGE TO SEE THAT FLOW METER SHOWS 10 GPM.
 - D.) MANUALLY ADVANCE TRUCK THROTTLE AN ADDITIONAL 500 – 700 RPM WHILE WATCHING FLOW GAUGE. FLOW SHOULD NOT EXCEED 10.5 GPM. IF FLOW EXCEEDS 10.5 GPM CONTACT MATWELD FOR TECHNICAL ASSISTANCE.
 - E.) IF FLOW DOES NOT EXCEED 10.5 GPM TEST IS COMPLETE.
11. RETURN TRUCK RPM TO IDLE, TURN VALVES OFF, SET EQUIPMENT/TOOL VALVE TO EQUIPMENT.

OPERATION:

1. ONCE THE VEHICLE IS IN PLACE AND THE TOOLS ARE READY TO BE USED, TURN THE **EQUIPMENT/TOOL CIRCUIT** VALVES TO THE **TOOLS** SETTING.
2. CONNECT THE TOOL TO BE USED TO THE PROPER FLOW PORT.
3. ADVANCE THROTTLE TO “TOOL RUN” POSITION. (THIS RPM SETTING MUST BE PROVIDED BY VEHICLE EQUIPMENT COMPANY.)
4. TO USE A 5 GPM TOOL, CONNECT THE TOOL TO THE 5 GPM PORT AND TURN THE CORRESPONDING VALVE TO THE “ON” POSITION.
5. TO USE A 10 GPM TOOL, CONNECT THE TOOL TO THE 10 GPM PORT AND TURN **BOTH** VALVES TO THE “**ON**” POSITION.

NOTE: WHEN USING A 10 GPM TOOL, NO OTHER TOOL CAN BE CONNECTED TO EITHER OF THE 5 GPM PORTS, EVEN IF THE TOOL IS NOT IN USE.

03000 HYDRAULIC MANIFOLD CIRCUIT

MAINTENANCE:

1. CHECK TOOL FOR OVERALL WORKING CONDITION **DAILY**.
2. INSPECT HOSES **DAILY**. AT THE FIRST SIGN OF ANY ABRASION OR CUT TO THE COVER, THE HOSES **MUST** BE CHANGED.
3. KEEP QUICK DISCONNECT COUPLERS **CLEAN & LUBRICATED**.
4. USE ONLY RECOMMENDED HYDRAULIC OILS. NEVER USE ATF OR MOTOR OIL.

SUGGESTED HYDRAULIC OILS:

AMOCO RYKON MV	CITGO A/W ALL TEMP
SUN 2105	MOBIL D.T.E. 15
CHEVRON EP-MV	TEXACO "RANDO" HD-AZ

IF YOUR LOCAL DISTRIBUTOR DOES NOT CARRY ANY OF THE ABOVE SUGGESTED HYDRAULIC OILS USE THE FOLLOWING GUIDELINES:

VISCOSITY @ 100° F.....	100-190SUS
VISCOSITY INDEX.....	MIN.150

EACH APPLICATION IS DIFFERENT, IF THERE ARE ANY QUESTIONS CONCERNING THE RIGHT CHOICE FOR YOUR PARTICULAR APPLICATION, CALL MATWELD FOR ASSISTANCE.

5. HAVE TOOL INSPECTED, AT LEAST ANNUALLY, BY A MATWELD OR MATWELD QUALIFIED SERVICE REPRESENTATIVE TO DETERMINE IF TOOL IS IN NEED OF SAFETY CHANGES OR WORN PART REPLACEMENT.

REVIEW OF HYDRAULIC PRINCIPLES

A. TOOL CIRCUIT

1. HYDRAULIC FORMULAS:

$$\text{GPM} = \frac{\text{CID} \times \text{RPM}}{231} \qquad \text{HP} = \frac{\text{GPM} \times \text{PSI}}{1456.9}$$

Example: HP required to deliver 10 GPM at 1500 PSI.

$$\frac{10 \text{ GPM} \times 1500 \text{ PSI}}{1456.9} = \frac{15000}{1456.9} = 10.3 \text{ HP}$$

(subtract back pressure for tool HP)

Estimated HP delivered by pump or used by tool.

GPM	PSI					
	500	1,000	1,500	2,000	2,500	3,000
3	1.03	2.06	3.09	4.12	5.15	6.18
5	1.72	3.43	5.15	6.86	8.58	10.30
10	3.43	6.86	10.3	13.70	17.20	20.60
15	5.15	10.30	15.40	20.60	25.70	30.90

2. BACK PRESSURE

BACK PRESSURE MEASURED AT THE TOOL RETURN PORT MUST NOT EXCEED THE MANUFACTURERS BACK PRESSURE RATING. MOST MANUFACTURERS LIST THE MAXIMUM BACK PRESSURE FOR THEIR HYDRAULIC TOOLS AT 250 PSI. BACK PRESSURE MEASURED ON THE RETURN SIDE OF THE TOOL IS THE FORCE REQUIRED TO GET THE OIL BACK TO THE TANK. IN ALMOST ALL CASES THE LOWER THE BACK PRESSURE THE BETTER THE TOOL PERFORMANCE. FIRST, THE BACK PRESSURE IS SUBTRACTED FROM THE MAXIMUM TOOL PRESSURE TO ARRIVE AT A MAXIMUM TOOL OPERATING PRESSURE. FOR EXAMPLE, TOOLS WITH 2000 PSI OPERATING PRESSURE ARE INSTALLED ON A SYSTEM WITH 250 PSI BACK PRESSURE. THIS LEAVES 1750 PSI AS A MAXIMUM TOOL PRESSURE. IMAGINE A SYSTEM WITH 500 PSI BACK PRESSURE. 2000 MINUS 500 PSI BACK PRESSURE LEAVES ONLY 1500 PSI FOR THE TOOL. SECOND, TOOLS ARE DESIGNED FOR PRESSURE TO BUILD ON THE PRESSURE SIDE OF THE TOOL. IF TOO MUCH PRESSURE BUILDS ON THE RETURN SIDE, NOT ONLY IS PERFORMANCE EFFECTED, BUT SEALS MAY BLOW. THIS IS WHY IT IS VERY IMPORTANT TO DIRECT THE FLOW INTO THE TOOL CORRECTLY. REVERSING THE HOSES TO TEST MAY RESULT IN BLOWN SEALS, DAMAGE TO THE TOOL, AND PERSONAL INJURY.

03000 HYDRAULIC MANIFOLD CIRCUIT

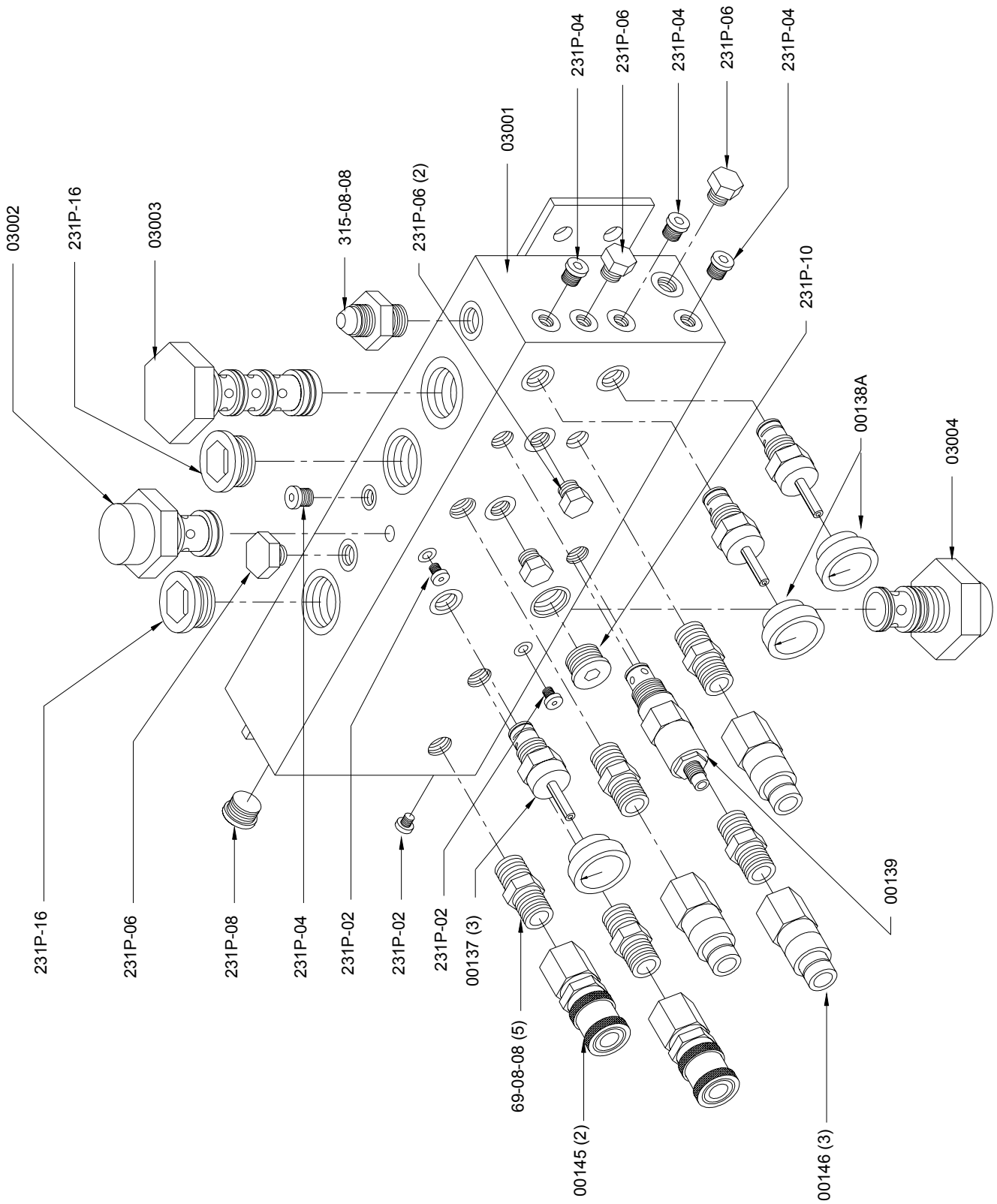

Matweld reserves the right to change parts, features, or specifications without notice.

03000 HYDRAULIC MANIFOLD CIRCUIT

CIRCUIT SELECTOR EQUIPMENT OR TOOL
USE IN TOOL POSITION ON POWER UNITS

MANIFOLD CONNECTONS

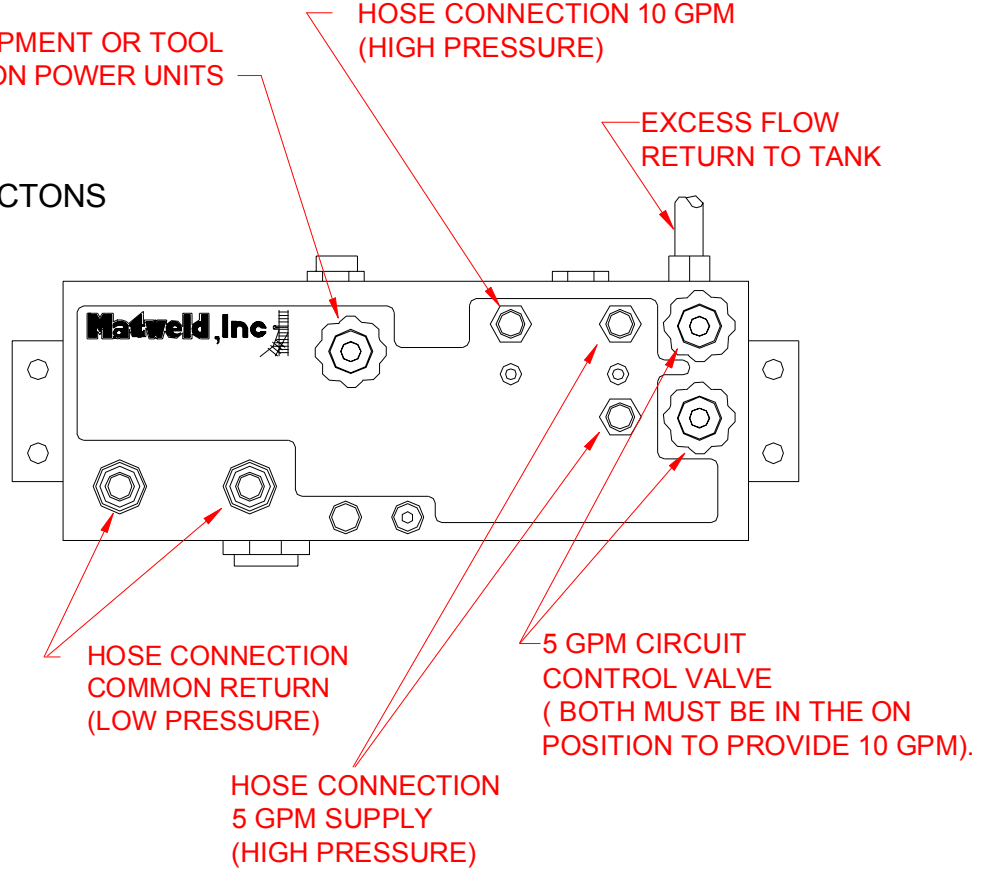

HYDRAULIC SCHEMATIC

RECOMMENDED HYDRAULIC TOOL CIRCUIT
(HOSE REELS OPTIONAL)

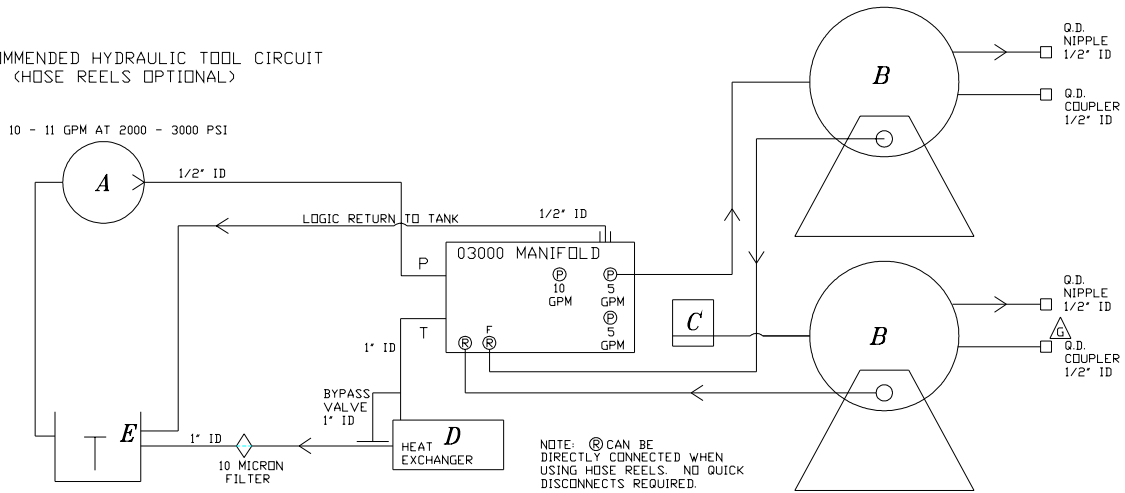

- A.** TOOL STAGE OF MULTI STAGE GEAR PUMP TO DELIVER 10 GPM AT 2000 PSI AT EST. 1000 - 1500 RPM. THROTTLE SET BY ELECTRIC SWITCH IN CLOSE PROXIMITY TO 03000 MANIFOLD.
- B.** HANNAY HOSE REEL MODEL 617-25-26B, IR: 3/4" BARCO. INSTALL 50' 1/2" ID WIRE BRAID HOSE RATED FOR 2000 PSI MINIMUM WORKING PRESSURE. INSTALL PROTECTIVE HOSE SLEEVE (PART #00350) ON TWIN HOSE.
- C.** QUICK DISCONNECT COUPLER AND PIGTAIL TO CONNECT TO 10 GPM OR 5 GPM CIRCUIT ON 03000 MANIFOLD.
- D.** HEAT EXCHANGER WITH THERMOSTAT CONTROLLED BY PASS VALVE FOR COLD WEATHER SHUT OFF.
- E.** IN TANK HEATER, THERMOSTAT CONTROLLED FOR COLD WEATHER OPERATION.

NOTES:

- ** VEHICLE BACK PRESSURE MEASURED AT 03000 MANIFOLD RETURN PORT (F) SHOULD NOT EXCEED 50 PSI AND TOTAL TOOL RETURN BACK PRESSURE MEASURED AT RETURN PORT (G) SHOULD NOT EXCEED 150 PSI FOR OPTIMUM TOOL PERFORMANCE. (OIL TEMPERATURE 85 F & FLOW 10 GPM)
- ** CALL MATWELD AT (502) 444-0085 FOR TECHNICAL ASSISTANCE.

MATWELD, INC.

PHONE:(270) 444-0085

FAX:(270) 443-6180

Matweld reserves the right to change parts, features, or specifications without notice.

05400 RIGHT ANGLE GRINDER

DECAL LEGEND

DCL-1014 OPERATION DECAL (NOT SHOWN)



DCL-1002

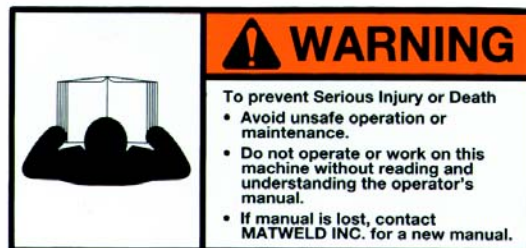

DCL-1001

LIMITED WARRANTY

MATWELD, INC., PADUCAH, KY., WARRANTS TO THE ORIGINAL PURCHASE OF THIS PRODUCT THAT THE PRODUCT WILL BE FREE FROM DEFECTS IN MATERIAL AND WORKMANSHIP FOR THE PERIOD OF ONE (1) YEAR AFTER THE DELIVERY OF SUCH PRODUCT TO THE CUSTOMER. OTHER EQUIPMENT AND PARTS USED, BUT NOT MANUFACTURED BY MATWELD INC. ARE COVERED DIRECTLY BY THE WARRANTY OF THE MANUFACTURER OF THOSE PRODUCTS. PROOF OF PURCHASE MUST BE DOCUMENTED INCLUDING REFERENCE TO A SERIAL NUMBER LOCATED ON EACH TOOL. THE PURCHASER'S ONLY REMEDIES UNDER THIS LIMITED WARRANTY SHALL BE LIMITED AT MATWELD'S SOLE OPTION TO THE FOLLOWING: REPAIR, REPLACEMENT OR REFUND OF THE PURCHASE PRICE OF THE DEFECTIVE PRODUCTS. EACH OF THESE REMEDIES REQUIRES TIMELY NOTIFICATION OF THE DEFECT IN THE PRODUCT AND SUBSTANTIATION THAT THE PRODUCT HAS BEEN PROPERLY STORED, MAINTAINED AND USED. MATWELD'S OBLIGATIONS HEREUNDER EXTEND ONLY TO THE PURCHASER OF THE PRODUCT AND NOT TO ANY THIRD PARTY.

AS A CONDITION PRECEDENT TO MATWELD'S OBLIGATION HEREUNDER, THE DEFECTIVE PRODUCT MUST NOT HAVE BEEN ALTERED OR MODIFIED WITHOUT THE EXPRESS WRITTEN APPROVAL OF MATWELD, INC. THE PRODUCT MUST NOT HAVE BEEN SUBJECTED TO DELIBERATE DAMAGE, SHIPPING DAMAGE, NEGLIGENCE, TAMPERING BY UNAUTHORIZED PERSONNEL OR DAMAGE BY IMPROPER USE, STORAGE OR MAINTENANCE. SERIAL NUMBERS MUST NOT HAVE BEEN ALTERED, DEFACED OR REMOVED. SUCH ACTION VOIDS LIMITED WARRANTY.

EXCLUSIONS TO LIMITED WARRANTY

THIS LIMITED WARRANTY IS EXCLUSIVE AND IS IN LIEU OF ANY OTHER WARRANTY, WRITTEN OR ORAL, EXPRESSED OR IMPLIED, INCLUDING, WITHOUT LIMITATION, ANY IMPLIED WARRANTY OR MERCHANTABILITY OR FITNESS FOR A PARTICULAR PURPOSE.

LIMITED WARRANTY DOES NOT COVER NORMAL WEAR AND TEAR ITEMS SUCH AS FILTERS, HOSES, COUPLERS, BITS, SOCKETS, AUGERS, AND BATTERIES.

LIMITATION OF LIABILITY

EXCEPT AS PROVIDED ABOVE, MATWELD SHALL IN NO EVENT BE LIABLE OR RESPONSIBLE FOR ANY INJURY, LOSS OR DAMAGE, DIRECT, INCIDENTAL OR CONSEQUENTIAL, ARISING OUT OF THE USE OR MISUSE OR INABILITY TO USE THE PRODUCT, HOWEVER CAUSED AND ON ANY THEORY OF LIABILITY INCLUDING, WITHOUT LIMITATIONS, BREACH OF CONTRACT, TORT, (INCLUDING NEGLIGENCE OR STREET LIABILITY) AND NOT WITHSTANDING ANY FAILURE OF ANY REMEDY HEREIN OF ITS ESSENTIAL PURPOSE, EVEN IF MATWELD WAS AWARE OF THIS POSSIBILITY OF SUCH DAMAGE. MATWELD'S LIMITED WARRANTY AS SET FORTH ABOVE SHALL NOT BE ENLARGED, DIMINISHED OR AFFECTED BY, AND NO OBLIGATION OR LIABILITY SHALL ARISE OR GO OUT OF THE RENDERING OF TECHNICAL ADVICE OR SERVICE BY MATWELD OR ITS AGENTS. THE FOREGOING MAY NOT BE CHANGED EXCEPT BY WRITTEN AGREEMENT SIGNED BY AN AUTHORIZED OFFICER OF MATWELD, THE REMEDIES SET FORTH HEREIN ARE EXCLUSIVE.

CUSTOMER INFORMATION:

Name _____

Company _____

Serial # of your Matweld tool _____

(Upon receiving your Matweld tool, make sure to list serial number above so that a good record is kept for order information.)

MATWELD HYDRAULIC TOOL LIST

All Matweld Hydraulic Tools operate at
5 or 10 GPM @ 2000 PSI

POWER UNITS:

70700 – HYDRA POWERED MODULAR SYSTEM

02900 – DIESEL 1-10 GPM OR 2-5 GPM

(OPTIONAL CATALYTIC EXHAUST AND/OR MSHA CERTIFIED)

00100 – GASOLINE 1-10 GPM OR 2-5 GPM

02050 – GASOLINE 1-5 GPM

TRACK TOOLS:

01600A – 1" IMPACT WRENCH

04500D – 1/2" IMPACT DRILL

00800A – 16" RAIL SAW

03900A – REVERSING RAIL SAW

01100 – SPIKE PULLER

01300A – TIE TAMPER

01400 – SPIKE DRIVER

01500 – RAIL DRILL

01000 – CHAIN SAW

GRINDERS:

04600 & 04650 – STRAIGHT STONE CW & TRIGGER VERSION

04700 & 04750 – STRAIGHT STONE CCW & TRIGGER VERSION

04800 & 04850 – CUPSTONE & TRIGGER VERSION

00700 – RAIL SURFACING GUIDE

04300 & 04350 – 6" PROFILE & TRIGGER VERSION

02400 – 10" OR 14" FROG AND SWITCH GRINDER

OTHER PRODUCTS:

HYDRAULIC MANIFOLDS

HYDRAULIC TEST GAUGES

HOSE REELS

HYDRAULIC HOSES

ACCESSORIES

MATWELD, INC.

PHONE:(270) 444-0085

FAX:(270) 443-6180

Matweld reserves the right to change parts, features, or specifications without notice.